



# QuARTz by ACO Specification Sheet

**ACO Polycrete Pty Ltd**  
1300 765 226  
sales@acoaus.com.au

DRG #: SC-Q-02

## ShowerChannel - Quadrato grate

**ACO Limited**  
0800 448 080  
sales@aconz.co.nz

www.quartzbyaco.com.au  
www.quartzbyaco.co.nz



### Quadrato grate

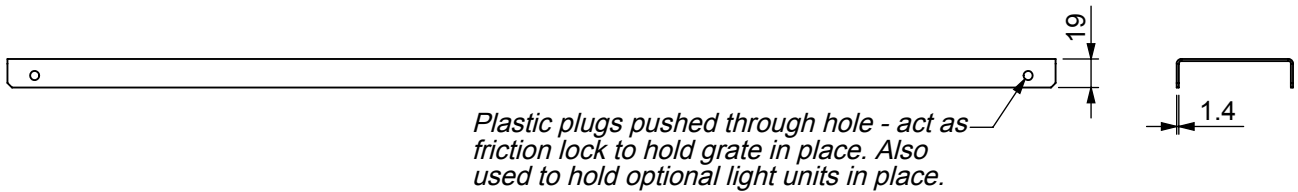
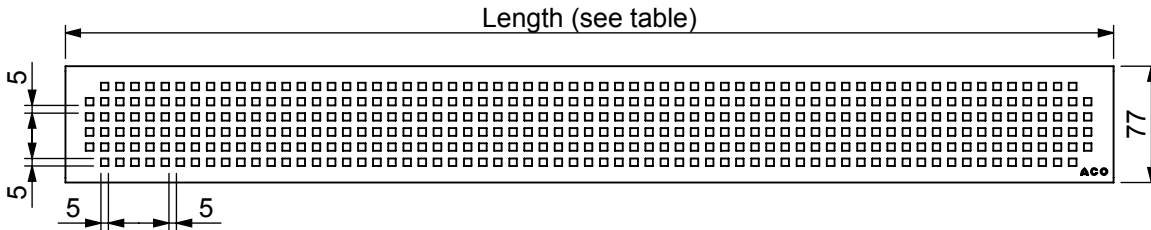

### Centre outlet channel option

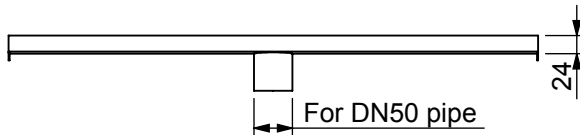
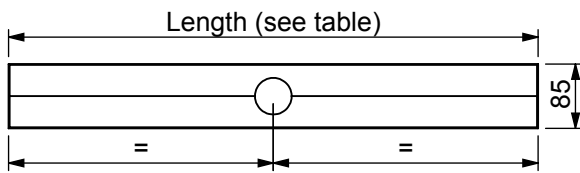

### End outlet channel option

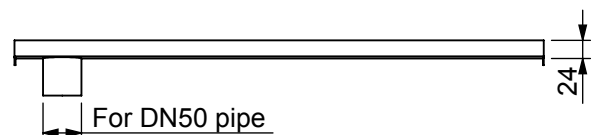
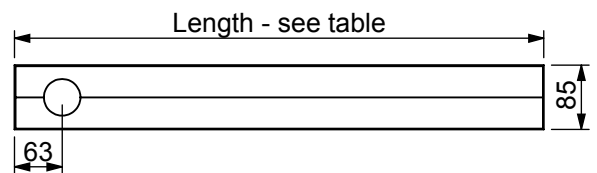

|                     |     |     |     |      |      |      |
|---------------------|-----|-----|-----|------|------|------|
| Length (mm)         | 700 | 800 | 900 | 1000 | 1200 | 1400 |
| Channel weight (kg) | 1.1 | 1.2 | 1.4 | 1.5  | 1.7  | 1.9  |
| Grate weight (kg)   | 1.2 | 1.3 | 1.4 | 1.6  | 1.7  | 1.8  |

# All dimensions are in millimeters

### Specification Clause

The QuARTz by ACO, ShowerChannel complete with Quadrato grate shall be stainless steel, grade 304 with electropolished surface.

Channel shall be 85mm wide and 24mm deep. The channel outlet is to suit a DN50 pipe. The length, as specified, on designers plans/specifications.

The system shall be manufactured and supplied by ACO Polycrete Pty Ltd and installed in accordance with ACO's guidelines.

Installers must check local plumbing codes and seek professional advice prior to installation.